

# POST RD.

3250 N. POST RD. - BLDG. 300 • INDIANAPOLIS, IN 46226

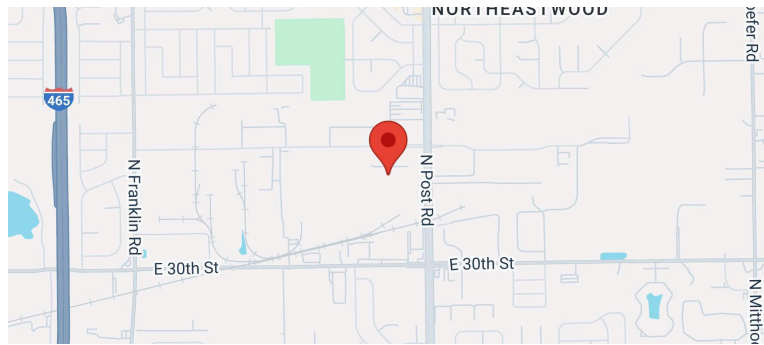

## Property Summary

AVAILABLE SF	SF
BUILDING SIZE	221,281 SF
YEAR BUILT	1988
MARKET	Indianapolis

Square Footage / Acres: 221,281 sqft & 11.2 Acres

Year Built: 1988

# of Buildings: 1

Post Road is a multi-tenant industrial warehouse.

- Access to to US Interstates 70 and 465, as well as downtown Indianapolis and Interstates 69 and 74
- Located 16 miles from Downtown Indianapolis & Indianapolis International Airport
- Dock and drive-in doors - Suite dependent
- Approximate clear height of 18 feet
- Responsive and dedicated management team

For more information, please contact:

**LIZ DEKONINCK**  
LEASING CONTACT  
P. 317.536.0093  
E. LIZ@HALAKAR.COM

# POST RD.

3250 N. POST RD. - BLDG. 300 • INDIANAPOLIS, IN 46226

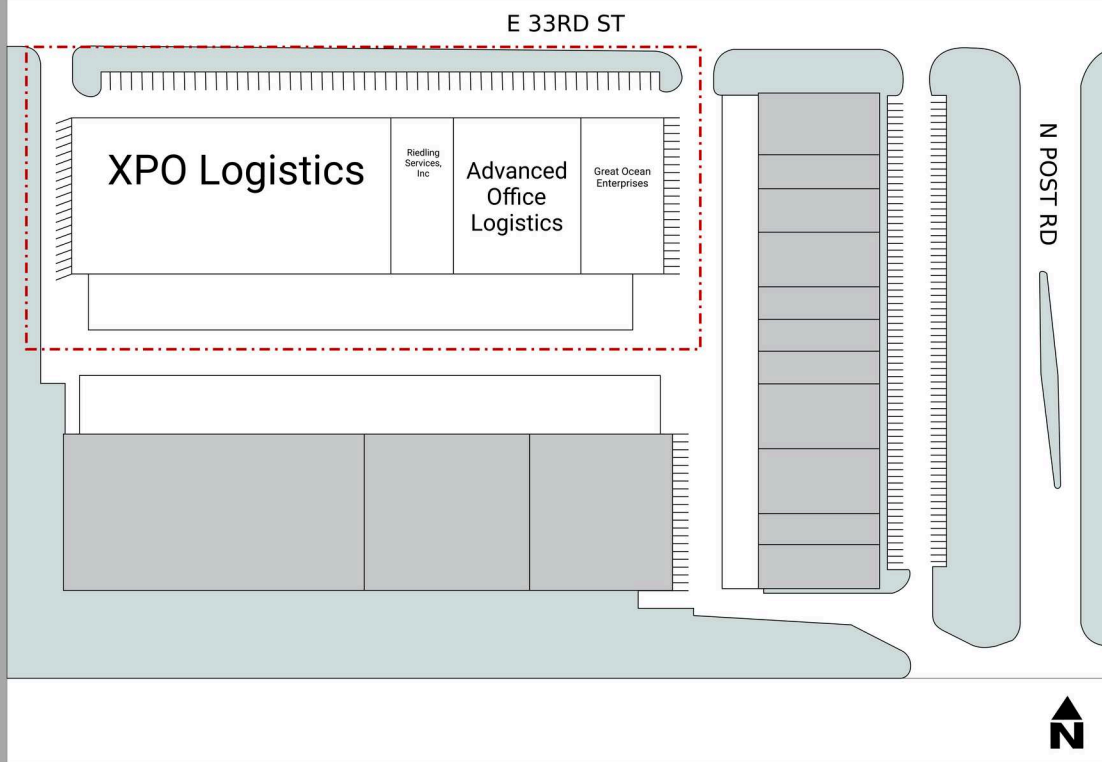

■ AVAILABLE    ■ OCCUPIED

## Current Availabilities

BUILDING	SUITE	TOTAL SIZE
Post Bldg 200	201	

# POST RD.

3250 N. POST RD. - BLDG. 300 • INDIANAPOLIS, IN 46226

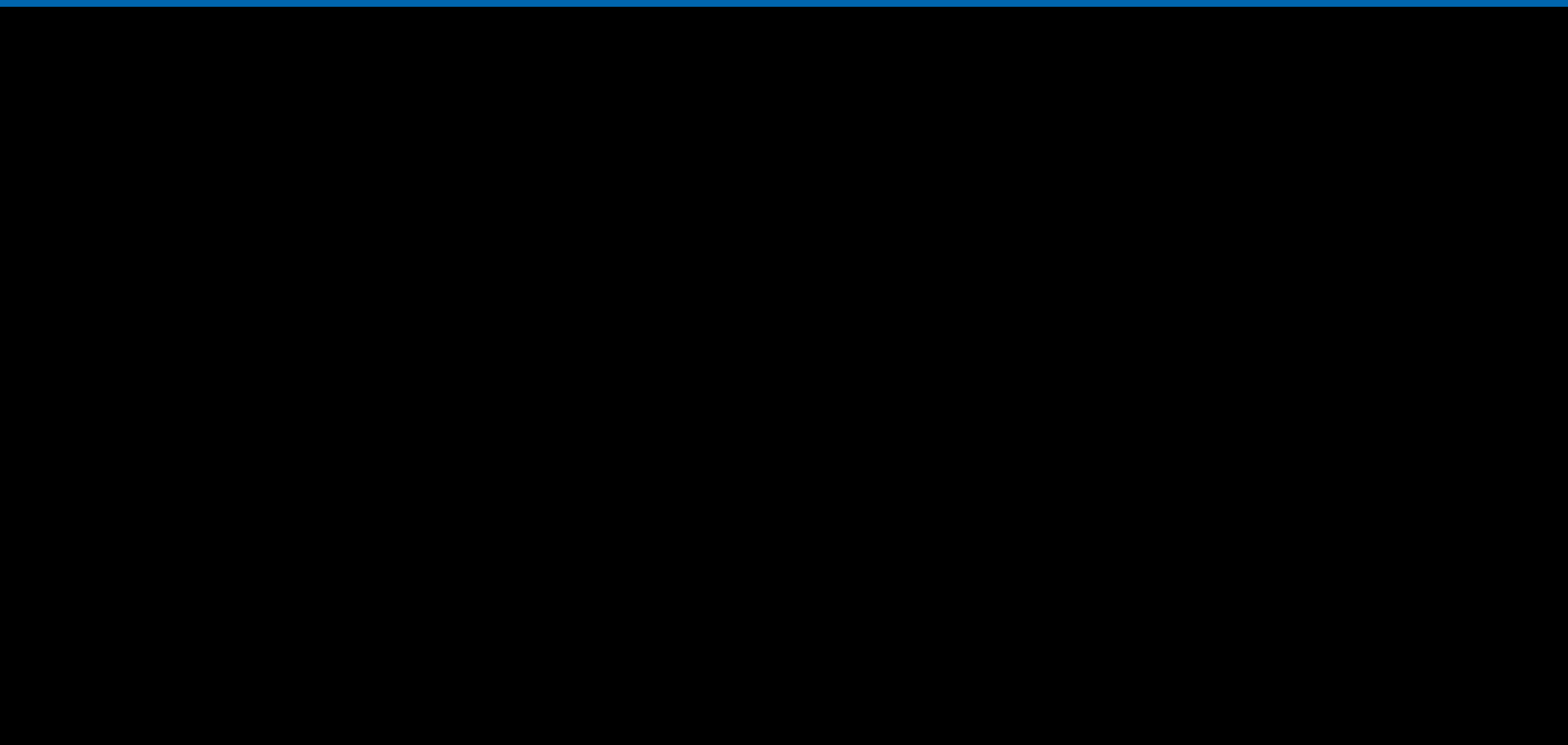

■ AVAILABLE    ■ OCCUPIED

## Current Availabilities

BUILDING	SUITE	TOTAL SIZE
Post Bldg 100	122	
Post Bldg 100	132	