

# CABOT POD

2260-1270 CABOT BLVD W • LANGHORNE, PA 19047

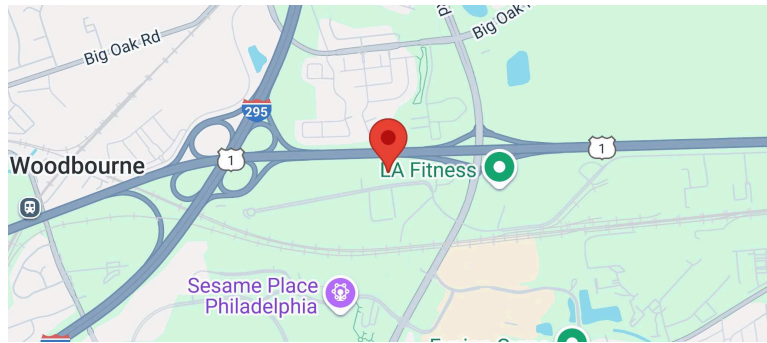

## Property Summary

<b>AVAILABLE SF</b>	2,188-7,827 SF
<b>BUILDING SIZE</b>	176,070 SF
<b>YEAR BUILT</b>	1984
<b>MARKET</b>	Langhorne

**For more information, please contact:**

**PATRICK LAFFERTY II**  
LEASING CONTACT  
P. 610.335.1084  
E. PLAFFERTY@LEE-ASSOCIATES.COM

Square Footage / Acres: 49,400 sqft & 11.56 Acres

Year Built: 1985

# of Buildings: 1

Cabot Pot is a flexible industrial space in the Bucks County Business Park in Langhorne, Pennsylvania.

- Located off Highway 1 with easy access to I-295, I-95 and the Pennsylvania Turnpike (I-276)
- Dock-high doors - Suite dependent
- Approximate clear height of 14-24 feet
- HVAC is rooftop-mounted
- Responsive and dedicated management team

# CABOT POD

2260-1270 CABOT BLVD W • LANGHORNE, PA 19047

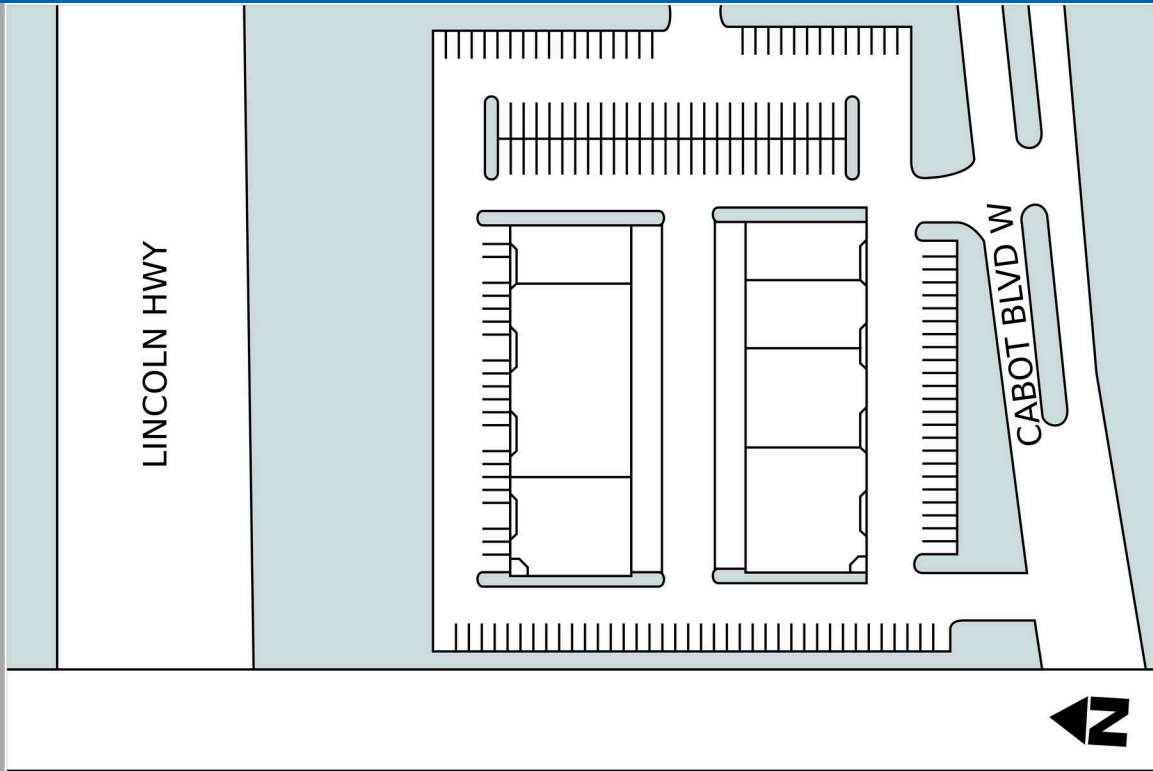

■ AVAILABLE    ■ OCCUPIED

## Current Availabilities

BUILDING	SUITE	TOTAL SIZE
2260/2270 Cabot	2260	2,796
2260/2270 Cabot	2261	5,876
2260/2270 Cabot	2263	3,841
2260/2270 Cabot	2264	2,188
2260/2270 Cabot	2271	2,265
2260/2270 Cabot	2272	7,827

# CABOT POD

2260-1270 CABOT BLVD W • LANGHORNE, PA 19047

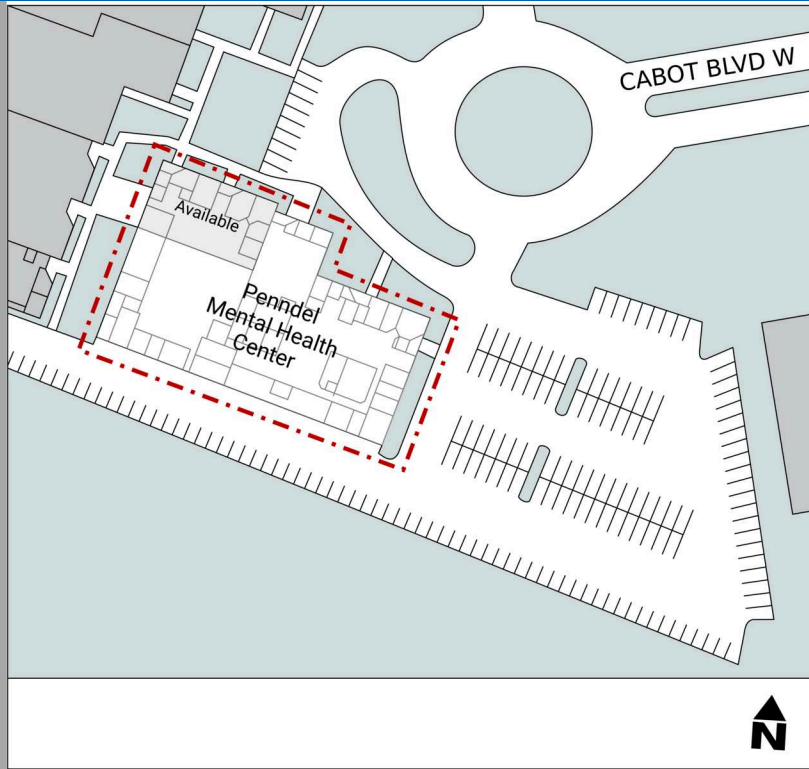

■ AVAILABLE    ■ OCCUPIED

## Current Availabilities

BUILDING	SUITE	TOTAL SIZE
2005 Cabot	00200	3,667